

Parts List

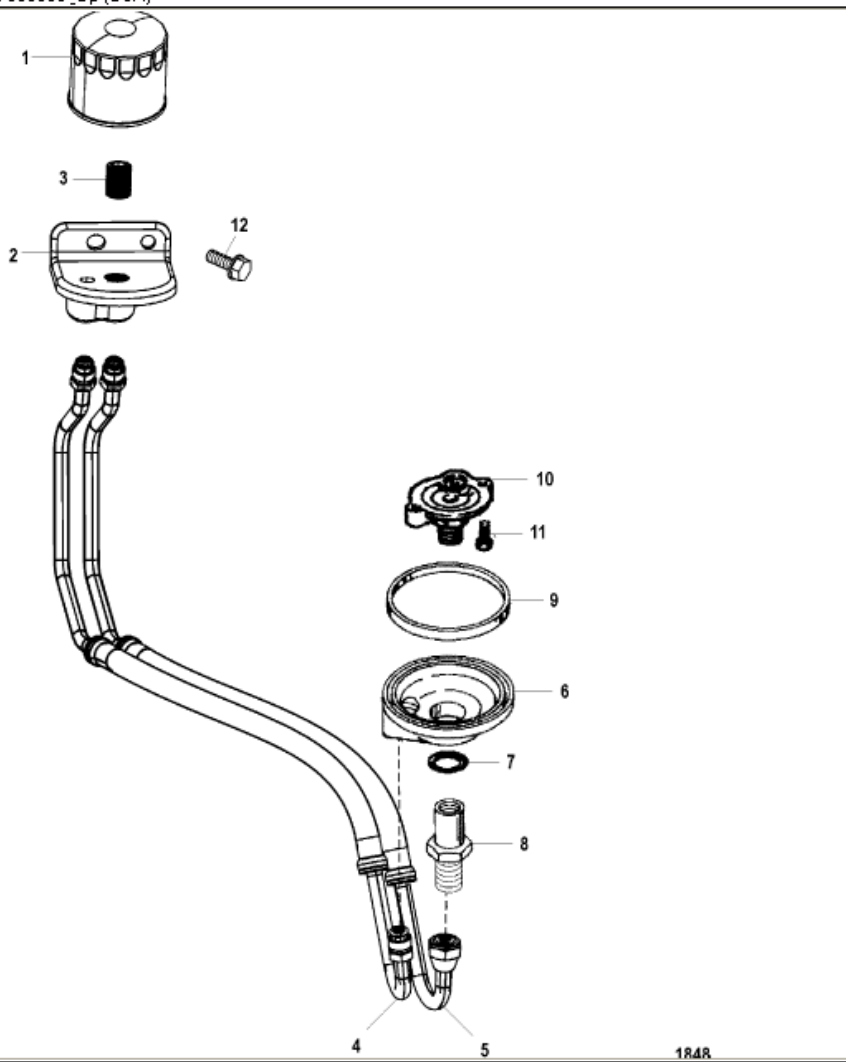

| Ref | Class | Part | Description | Qty | Comment | Footnote |
|-----|-------|-----------|-----------------------------|-----|-------------------------------------|----------|
| 1 | 35 | 866340Q02 | OIL FILTER | 1 | (Quicksilver Brand) | |
| 1 | 35 | 866340K01 | OIL FILTER | 1 | (Mercury Precision Parts Brand) | |
| 2 | | 863732T 1 | BRACKET, Oil Filter | 1 | | |
| 3 | 22 | 863485 | FITTING, Oil Filter | 1 | | |
| 4 | 32 | 864557 | HOSE, Oil | 1 | (From Adaptor) | |
| 4 | 32 | 865056 | HOSE, Oil | 1 | (V Drive)(From Adaptor) | |
| 5 | 32 | 864556 | HOSE, Oil | 1 | (To Adaptor) | |
| 5 | 32 | 865055 | HOSE, Oil | 1 | (V Drive)(To Adaptor)(V Drive)(To , | |
| 6 | 35 | 818400A 1 | ADAPTOR | 1 | | |
| 7 | 26 | 42077 | SEAL | 1 | | 2 |
| 8 | 22 | 806121 | FITTING | 1 | | |
| 9 | 27 | 91892 | GASKET | 1 | | 2 |
| 10 | | 71920 | VALVE ASSEMBLY, Filter | 1 | | |
| 11 | 10 | 54786 | SCREW, (.312-18 x 1.250) | 2 | | |
| - | 27 | 861246A05 | GASKET SET, Engine Overhaul | 1 | | |